

The essential tool
for all projects

Pro-Fit
Innovations

MagicGripper



The Magic Gripper is unique that it uses the weight of the door or panel to automatically clamp and automatically releases when the product is lifted, thus acting as a second pair of hands.

The Magic Gripper has many uses - it's the essential tool for all projects.

www.pro-fitinnovations.co.uk

Parts List

2 x Gripper, left

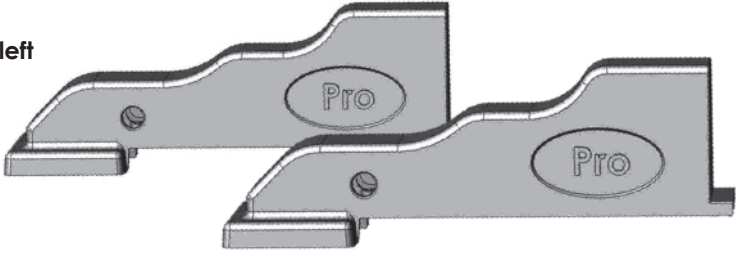

2 x Gripper, right

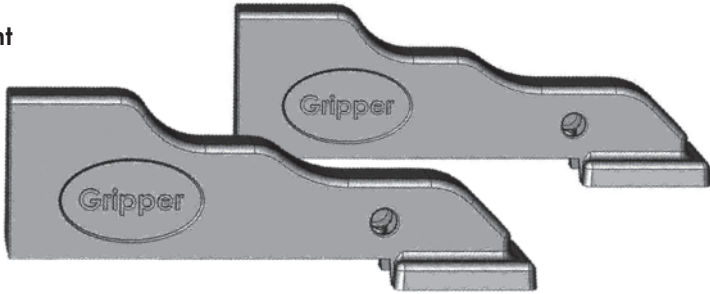

2 x Sprung Hinge

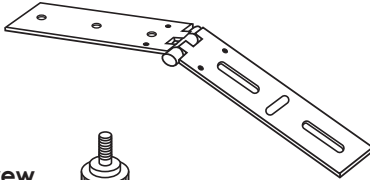

4 x M6 Knurled screw



6 x Pan head Posi screw



IMPORTANT NOTICE - DO NOT BEND

This product is NOT designed to fold
- DO NOT FORCE BEND

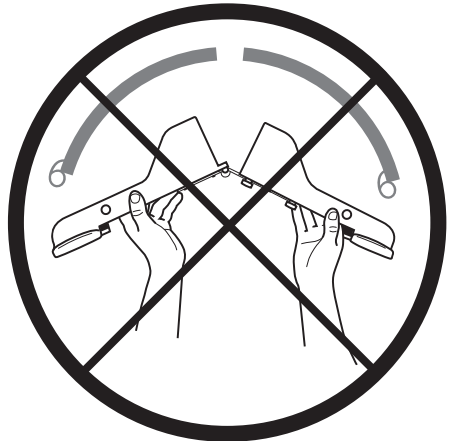

Assembly Instructions

A

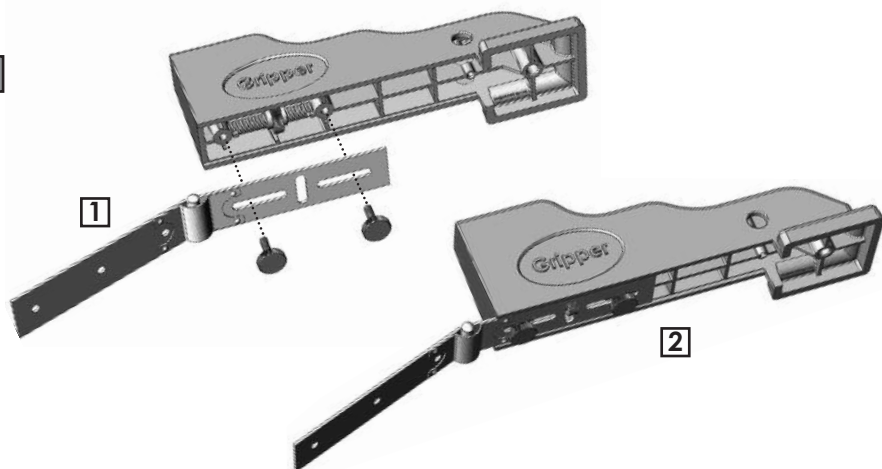

B

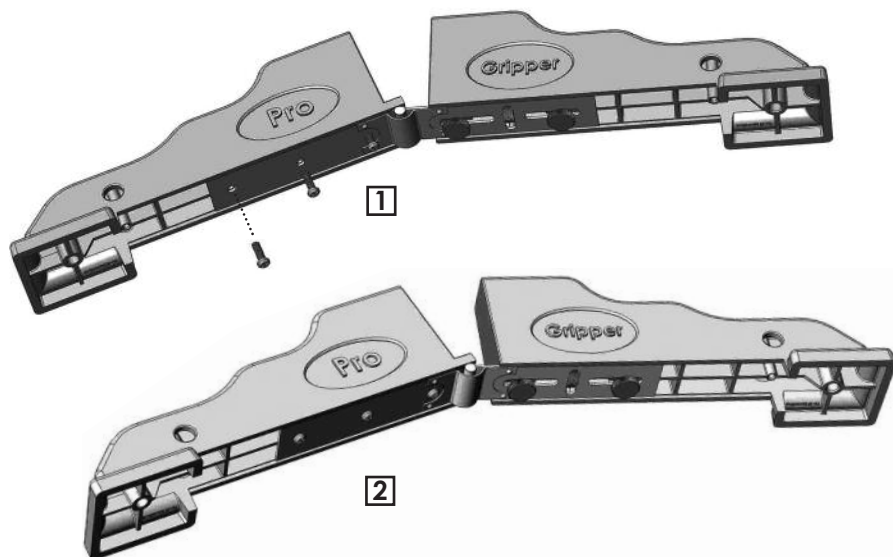

How to adjust

1. Undo the thumb screws.
2. Slide the gripper over the product.
3. Dial the thumb screw up or down to desired opening or until there is no slop.
4. Re-tighten the thumb screws.
5. For further info see new video at pro-fitinnovations.co.uk

TECHNICAL DATA*

- **Dimensions:** 360mm x 190mm x 170mm
- **Opening Dimensions:** 15 - 55mm approx
- **Materials:** Plastic RP and GF30 Steel Hinge
- **Weight** 3kg
- **6mm thumb turn locking screws and 12mm thumb turn dial adjustment nut**

* All measurements and weights are approx and are subject to change at any time at Company discretion.

WARRANTY

In line with statutory regulations this product has a 12 month warranty, starting from the date of purchase.

A copy of the receipt is sufficient proof in the event of claim subject to warranty. Damage due to regular wear, transport, overloading, failure to observe the instructions of assembly/ operation or improper handling are not covered by the warranty. The same applies to wear parts.

The manufacturer is not liable for indirect consequences and damage to property. The period of warranty is not renewed or extended following possible repair. Claims under the warranty are only recognised if the complete product is sent, shipping paid, to the manufacturer, the distributor or the service centre listed below.

IMPORTANT NOTICES

Product Changes: Pro-fit Innovations reserves the right to make changes in design, appearance and construction of any and all products listed herein without incurring any obligation in making such changes in products previously sold or transferred.

PRO-FIT INNOVATIONS also reserves the right to discontinue the availability of any products at such time as such action is considered necessary.

Liability: Pro-fit Innovations cannot accept the responsibility for the results of using Magic Grippers which have been abused or badly worn. PRO-FIT INNOVATIONS also cannot accept responsibility for results of using Magic Grippers incorrectly or using Magic Grippers which have been improperly maintained.

Safety Tips: Pro-fit Innovations encourages tool safety and proper tools use. We suggest you refer to the instructions for do's and don't's when and where provided.

DO NOT

This product is NOT designed to fold. Do not force bend.

Please DO NOT drop product into the Grippers. Place the product into the jaws and allow grippers to clamp securely.

Patent number EP 1989476

Copyright © Pro-fit Innovations Ltd.
All rights reserved.